



Broadhurst Gardens NW6

Parkheath  
*Sold on Service*



RAILWAY  
HOTEL

THE RAILWAY

THE  
RAILWAY

167  
Broadhurst Gardens

RESIDENTIAL  
ZONE  
No. 167  
Broadhurst Gardens

Cash

DAE



## **Broadhurst Gardens, NW6**

### **£585,000**

### **Leasehold**

- 2 bedroom apartment in the heart of West Hampstead
- 2nd floor within period building
- Under floor heating (except in the bathroom)
- 2 double bedrooms with fitted carpet
- Luxury bathroom
- Reception room with wood flooring
- Open plan kitchen with integrated appliances
- Large communal storage room with a bike rack
- Secure private storage cupboard in the basement
- Situated within a couple of hundred yards of West Hampstead underground station

Belsize Park/Hampstead  
208 Haverstock Hill  
NW3 2AG  
Sales 020 7431 1234  
Lettings 020 7431 3104  
[nw3@parkheath.com](mailto:nw3@parkheath.com)

South/West Hampstead  
192 West End Lane  
NW6 1SG  
Sales & Lettings  
Tel 020 7794 7111  
[192@parkheath.com](mailto:192@parkheath.com)

Kensal Rise  
54-56 Chamberlayne Rd  
NW10 3JH  
Tel 020 8960 4845  
[kensal@parkheath.com](mailto:kensal@parkheath.com)

Property Management  
192 West End Lane  
NW6 1SG  
020 7433 6174  
[pm@parkheath.com](mailto:pm@parkheath.com)

**Parkheath**  
*Sold on Service*

**Camden Tax band C**

[www.parkheath.com](http://www.parkheath.com)

## Broadhurst Gardens

Approximate Gross Internal Area = 62.00 sq m / 669 sq ft

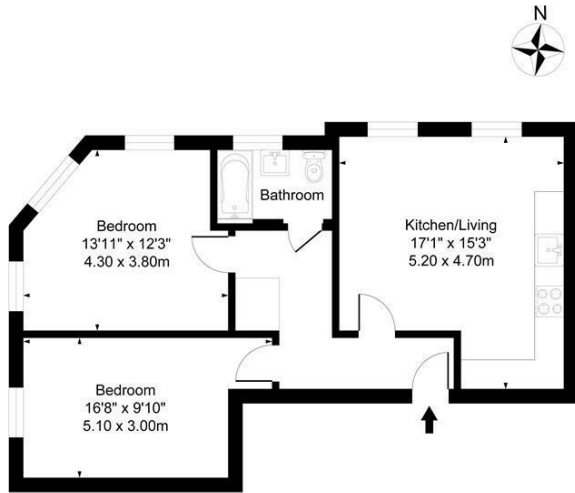

Second Floor

This plan is for layout guidance only. Drawn in accordance with RICS guidelines. Not drawn to scale unless stated. Windows & door openings are approximate. Whilst every care is taken in the preparation of this plan, please check all dimensions, shapes & bearings before making any decisions reliant upon them.

ELLIE CLAIRE PHOTOGRAPHY LTD  
www.ellieclairephotography.com

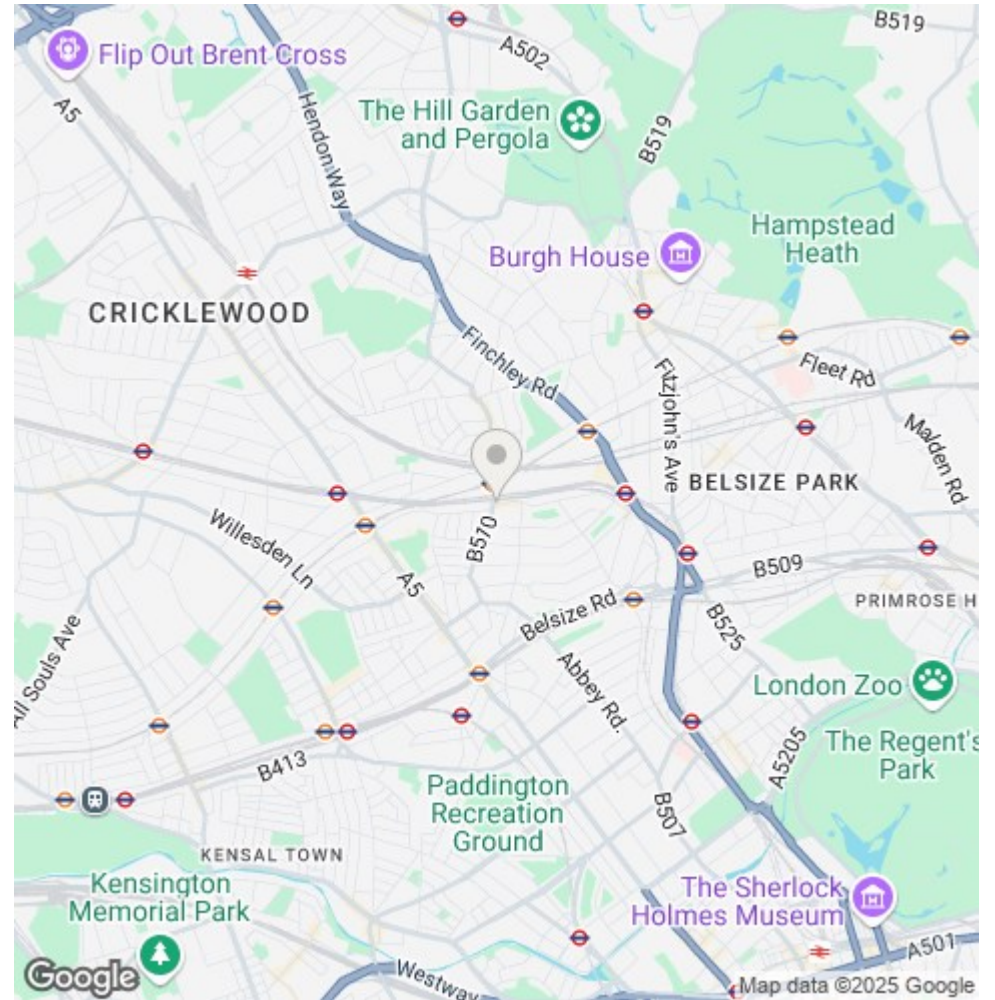

The particulars do not constitute part of an offer or contract. The particulars, including text, photographs and plans, are for the guidance only of prospective purchasers/tenants and must not be relied upon as statements of fact. The descriptions provided therein represent the opinion of the author and whilst given in good faith should not be construed as statements of fact. Nothing in these particulars shall be deemed a statement that the property is in good condition or otherwise or that any services or facilities are in good working order. All measurements are approximate